

**BETHUNE AVE
November 16, 2024**

**between
to**

**SAANICH RD AND CLOVERDALE AVE
November 22, 2024**



The data presented here is for information purposes only and should not be considered authoritative for construction, geotechnical, engineering, navigational, legal, or other site-specific uses. Please note that small datasets may skew the calculation of the hourly 85th percentile speed. The information shared is owned by the Transportation Division of the Engineering Department at the District of Saanich. Accuracy is not guaranteed.

This document contains:

Overview

Vehicle Volume Summary

Vehicle Speed Summary

Vehicle Classification Summary

Overview

BETHUNE AVE
November 16, 2024

between
to

SAANICH RD AND CLOVERDALE AVE
November 22, 2024



Location Map

Metric	NB	SB	Combined
Average Traffic Volume (weekdays)	316	364	680
Average Speed (km/h)	34	33	33

Weather Information	Value
Minimum Temperature	3 °C
Maximum Temperature	12 °C
Total Precipitation	10 mm

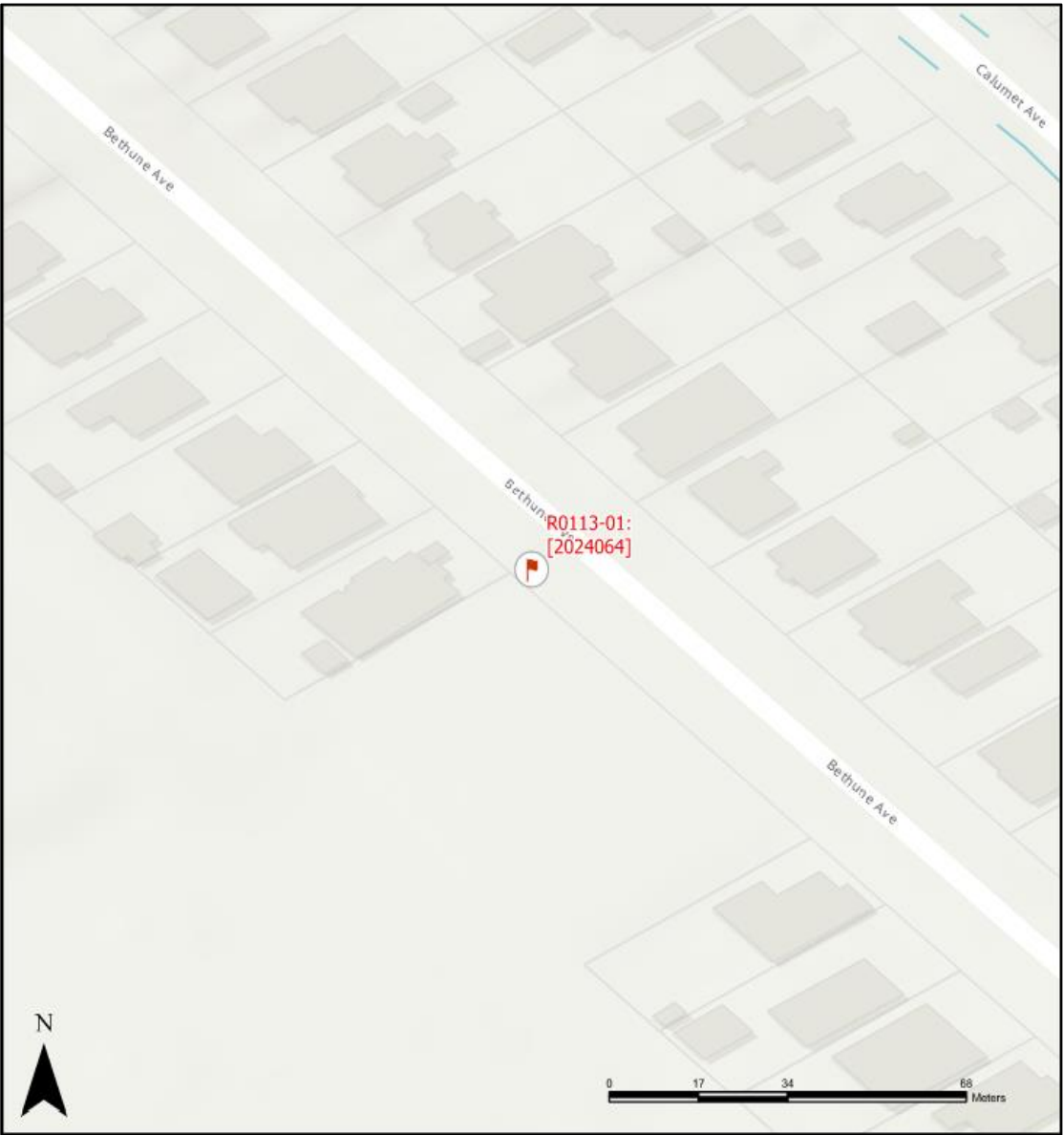

Vehicle Volume Summary



Start Date: 11/16/2024
Start Time: 12:00 AM
Station ID: R0113-01

Location: BETHUNE AVE Between SAANICH RD AND CLOVERDALE AVE

DATE:	November 18, 2024		November 19, 2024		November 20, 2024		November 21, 2024		November 22, 2024					
	MON		TUE		WED		THURS		FRI		WK AVG		WK AVG	HOURLY
Time:	NB	SB	NB	SB	NB	SB	NB	SB	NB	SB	NB	SB	CH 1+2	%
12-1 AM	0	1	0	0	0	1	3	3	4	2	1	1	3	0.4%
1-2 AM	0	0	1	1	2	2	1	0	2	1	1	1	2	0.3%
2-3 AM	0	1	2	1	3	1	1	2	5	1	2	1	3	0.5%
3-4 AM	0	0	0	1	1	0	2	1	1	0	1	0	1	0.2%
4-5 AM	0	0	1	0	0	1	2	1	0	0	1	0	1	0.1%
5-6 AM	3	2	0	1	0	2	1	2	1	1	1	2	3	0.4%
6-7 AM	2	9	4	7	2	4	4	7	2	4	3	6	9	1.3%
7-8 AM	7	22	8	26	10	26	7	22	3	27	7	25	32	4.6%
8-9 AM	14	33	17	41	21	39	21	37	11	21	17	34	51	7.5%
9-10 AM	21	25	10	30	19	27	16	31	9	15	15	26	41	6.0%
10-11 AM	11	13	16	21	9	23	15	23	15	23	13	21	34	5.0%
11-12 PM	10	11	19	22	13	20	16	14	24	27	16	19	35	5.2%
12-1 PM	11	20	13	22	17	32	22	30	23	32	17	27	44	6.5%
1-2 PM	16	19	20	23	19	27	24	21	27	25	21	23	44	6.5%
2-3 PM	26	21	26	28	34	26	27	25	23	18	27	24	51	7.5%
3-4 PM	29	27	34	18	24	24	27	31	22	26	27	25	52	7.7%
4-5 PM	27	28	44	28	44	32	54	37	34	31	41	31	72	10.6%
5-6 PM	38	23	33	22	51	46	42	27	28	23	38	28	67	9.8%
6-7 PM	9	19	17	20	16	19	21	28	20	26	17	22	39	5.7%
7-8 PM	22	14	14	14	21	21	10	12	18	21	17	16	33	4.9%
8-9 PM	7	6	9	9	5	11	20	16	7	11	10	11	20	3.0%
9-10 PM	4	10	8	10	12	13	10	7	7	12	8	10	19	2.7%
10-11 PM	7	4	9	7	8	4	8	6	6	8	8	6	13	2.0%
11-12 AM	4	6	8	2	3	2	10	7	10	5	7	4	11	1.7%
LANES	268	314	313	354	334	403	364	390	302	360	316	364	680	100.0%
TOTAL	582		667		737		754		662		680			
	MON		TUE		WED		THURS		FRI		WK AVG			
PEAK HOUR							TOTAL VEHICLES-PEAK PERIODS				2 HOUR PEAK INTERVALS			
MAX. 7 - 9 am PEAK HOUR		51	➡	7.5%	between	8-9 AM	301 ➡ 6 HR TOTAL		2 HR AM (7 - 9 AM)					
MAX. 7 - 11 am PEAK HOUR		51	➡	7.5%	between	8-9 AM	221 ➡ 4 HR TOTAL		VEH / HR					
MAX. 11 am - 1 pm PEAK		44	➡	6.5%	between	12-1 PM	24 HOUR FACTORS		2 HR NOON (11 - 1 PM)					
MAX. 11 am - 3 pm PEAK		51	➡	7.5%	between	2-3 PM			VEH / HR					
MAX. 4 - 6 pm PEAK HOUR		72	➡	10.6%	between	4-5 PM			VEH / HR					
MAX. 3 - 6 pm PEAK HOUR		72	➡	10.6%	between	4-5 PM	2.26 ➡ 6-24 HR FACT.		2 HR PM (4 - 6 PM)					
							3.08 ➡ 4-24 HR FACT.		VEH / HR					
									2 HR %					
									2 HR %					
									2 HR %					
									2 HR %					
									2 HR %					
									2 HR %					
									2 HR %					
									2 HR %					
									2 HR %					
									2 HR %					
									2 HR %					
									2 HR %					
									2 HR %					
									2 HR %					
									2 HR %					
									2 HR %					
									2 HR %					
									2 HR %					
									2 HR %					
									2 HR %					
									2 HR %					
									2 HR %					
									2 HR %					
									2 HR %					
									2 HR %					
									2 HR %					
									2 HR %					
									2 HR %					
									2 HR %					
									2 HR %					
									2 HR %					
									2 HR %					
									2 HR %					
									2 HR %					
									2 HR %					
									2 HR %					
									2 HR %					
									2 HR %					
									2 HR %					
									2 HR %					
									2 HR %					
									2 HR %					
									2 HR %					
									2 HR %					
									2 HR %					
									2 HR %					
									2 HR %					
									2 HR %					
									2 HR %					
									2 HR %					
									2 HR %					
									2 HR %					
									2 HR %					
									2 HR %					
									2 HR %					
									2 HR %					
									2 HR %					
									2 HR %					
									2 HR %					
									2 HR %					
									2 HR %					

Vehicle Speed Summary



Station ID: R0113-01
Location: BETHUNE AVE between SAANICH RD AND CLOVERDALE AVE
Dates: 11/16/2024 to 11/22/2024

Bin Number	1	2	3	4	5	6	7	8	9	10	11	12	13	14
Bin Speeds	1-20	21-25	26-30	31-35	36-40	41-45	46-50	51-55	56-60	61-65	66-70	71-80	81-90	91-9999
Count Total	209	363	841	1237	981	469	137	29	6	0	0	0	0	0
Percent Total	5%	8%	20%	29%	23%	11%	3%	1%	0%	0%	0%	0%	0%	0%

Movements	Above 30 km/h	Above 40 km/h	Above 50 km/h
NB	69%	18%	1%
SB	65%	13%	1%
Combined	67%	15%	1%

Movements	Average Speed	85th Percentile Speed	95th Percentile Speed
NB	34 km/h	41 km/h	45 km/h
SB	33 km/h	40 km/h	44 km/h
Combined	33 km/h	40 km/h	45 km/h

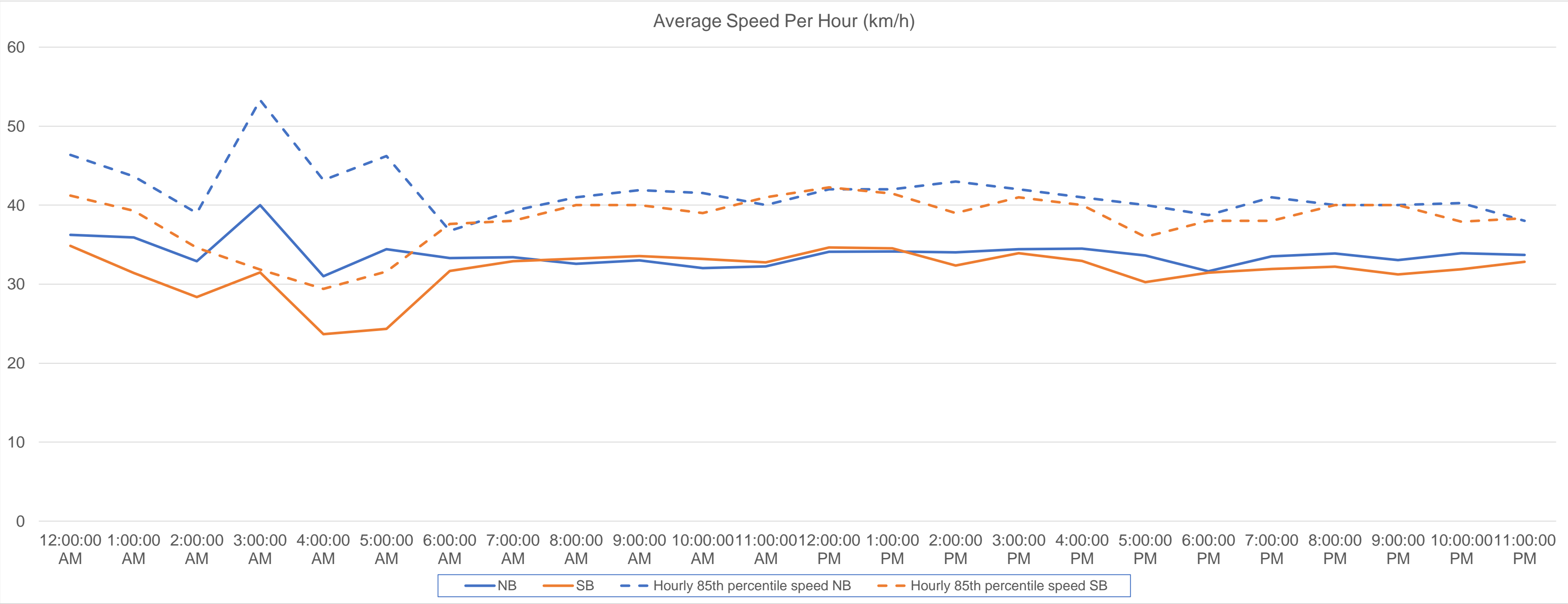

Vehicle Class Summary



Station ID R0113-01
Location: BETHUNE AVE between SAANICH RD AND CLOVERDALE AVE
Dates: 11/16/2024 to 11/22/2024

Classification	Motorcycle	Car & Light Goods Vehicles	Single Unit Truck	Buses	Multi-trailer truck
Length	0m to 2.30m	4.00m to 6.90m	6.00m to 10.50m	9.50m to 13.70m	9.50m to 23.70m

Movement	Classification					Total
	Motorcycle	Car & Light Goods Vehicles	Single Unit Truck	Buses	Multi-trailer truck	
NB	10	1937	22	0	0	1969
SB	4	2292	19	1	0	2316
Total	14	4229	41	1	0	4285
Percentage of Total	0.33%	98.69%	0.96%	0.02%	0.00%	100.00%